

Vandal Resistant Switch

Ø25mm



- Anti-Vandal IK09/ Sealed IP65
- Illuminated and Non-Illuminated
- Flat/ Concave
- Momentary/ Latching
- Variety of colors



Momentary: Без фиксации
Latching: С фиксацией

Order Code

Series	Actuator Options	Terminal	Function	Material Finish	Illuminated Options	Color	Color Voltage	Marking Options
25-mm	F: Flat C: *Concave	Pin(2.8x0.5) blank	M: Momentary 1- 1N01NC 2- 2N02NC Z: Latching 1- 1N01NC 2- 2N02NC	S: Stainless Steel A: *Anodized Aluminum	D: Dot R: Ring Non-illuminated blank	W: White Y: Yellow B: Blue G: Green R: Red O: Orange	6V 12V 24V 36V 110V 230V	Custom Markings Available



Technical Data

Type	25-mm F	25-mm F/R	25-mm F/D
Illuminated Options	Non-Illuminated	Ring	Dot
Terminal	Pin(2.8X0.5)		
Max. Switch Rating	5A 250VAC		
Contact Resistance	≤ 50m Ω		
Insulation Resistance	≥ 1000m Ω		
Dielectric Strength	2000VAC		
Operation Temp.	-20 C ~ +55 C		
Mechanical Life	1,000,000cycles		
Electrical Life	200,000cycles		
Contact Material	Silver Alloy		
Torque	5 ~ 14Nm		
Operation Pressure	5approx.8N		
Protection	IP65		
Material			
Actuator	Stainless Steel/ *Anodized Aluminum		
Body	Stainless Steel/ *Anodized Aluminum		
Base	PA		
Color			
Type	LED		
Voltage	6V/ 12V/ 24V/ 36V/ 110V/ 230V		
Color	R G Y O B W		
Life	Approx. 40, 000hours		

*Material and Color voltage can be customized.

Operation



Description



'+' and '-' for LED Lamp

Panel Cutout

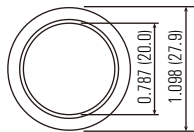
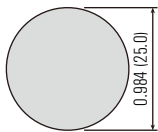

Max. Panel Thickness:
Momentary Version: 0.394 (10.0)
Latching Version: 0.472 (12.0)

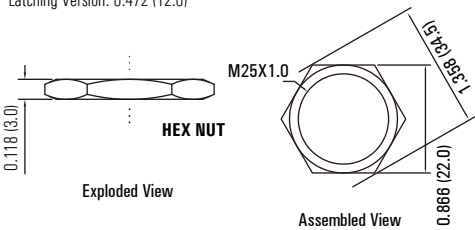

Dimension

